

REORDER POINT

WALKTHROUGH

Access the WebPOS home page (URL <http://www.alliancepos.net>) and click on Headquarter System.

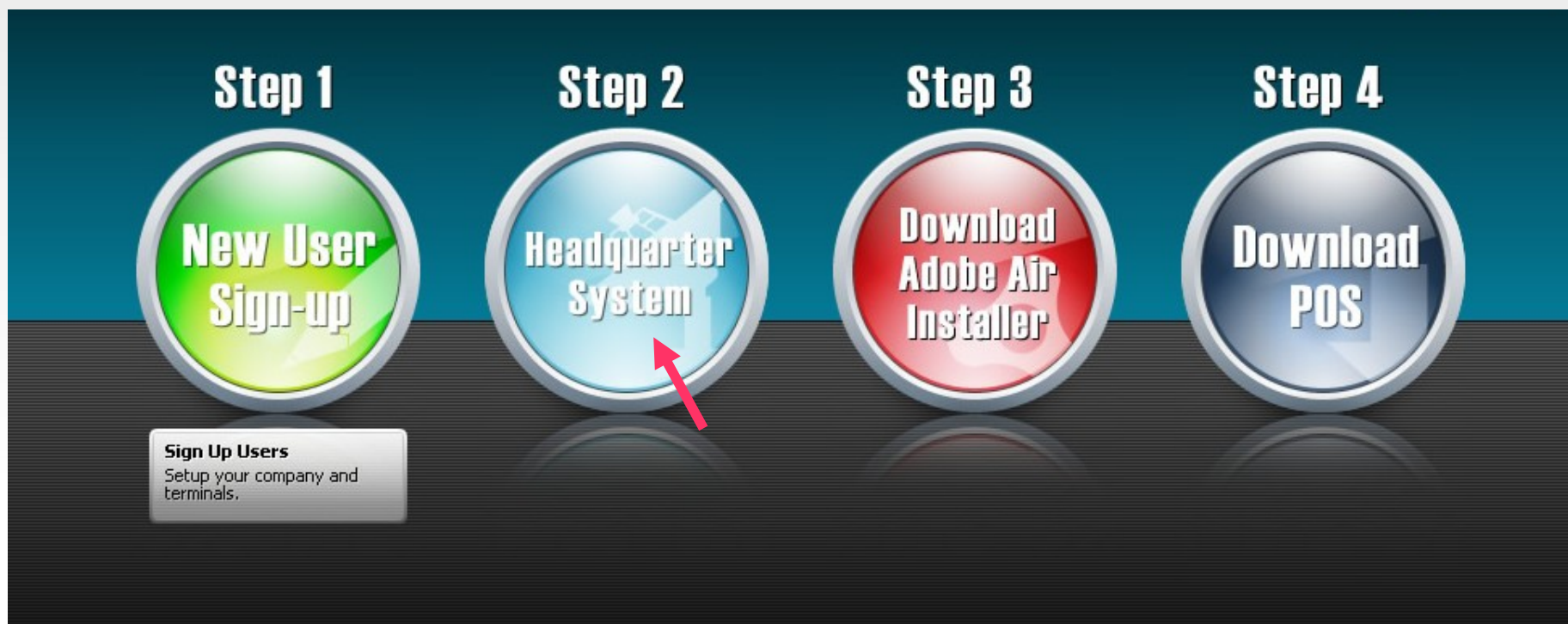

To add products, click on Master Records > Product Maintenance > Product Master

The screenshot shows a software interface with a top navigation bar containing: Home, Daily Operation, Sales Report, Inventory, Master Records, Maintenance, and Logout. The 'Master Records' menu is open, displaying a list of options: Account Master, Customer Group/Type, Price Level Master, Product Maintenance (with a right-pointing arrow), Branch Master, Warehouse Master, Region Master, Bank Master, Cash Master, Credit Master, Gift Certificate Type, and Master Listing (with a right-pointing arrow). The 'Product Maintenance' sub-menu is also open, listing: Product Master (highlighted in blue), Product Class, Product Category, Product Attribute, Unit of Measure, and Generic Name. On the left, a 'Sales Dashboard' is visible with a 'Sales Trend' bar chart. On the right, a 'Revenue' bar chart shows data for '1.Product Kit', '2.Nokia E72', and '3.Blackbe'. The interface includes various filters like 'Branch: (All)', 'Date: 02/08/2012', and 'Period: J'.

Reorder Point can only be set for the following Product Types:

General Inventory

Lot/Serial Inventory

Enter Reorder Quantity – optimal level of inventory when an order has to be made with the supplier.

The image shows two screenshots of a software interface for setting reorder points. The top screenshot is for 'General Inventory' and the bottom is for 'Lot/Serial Inventory'. Both screenshots show a 'Reorder Quantity' field with the value '0' and a 'Reorder Per Warehouse' button. A red oval highlights the 'Reorder Quantity' field and the 'Reorder Per Warehouse' button in both screenshots. Below the 'Reorder Quantity' field, there is a blue italicized note: '(Standard Quantity Per Warehouse, enter 0 to exempt from tracking)'. The 'Supplier ID' field is also visible in both screenshots.

You can also set Reorder Per Warehouse if you want to set different reorder points for your different warehouses

