

SETUP A COMPANY

WALKTHROUGH

Access the WebPOS home page (URL <http://www.alliancepos.net>) and click on New User Sign-up to start using WebPOS.

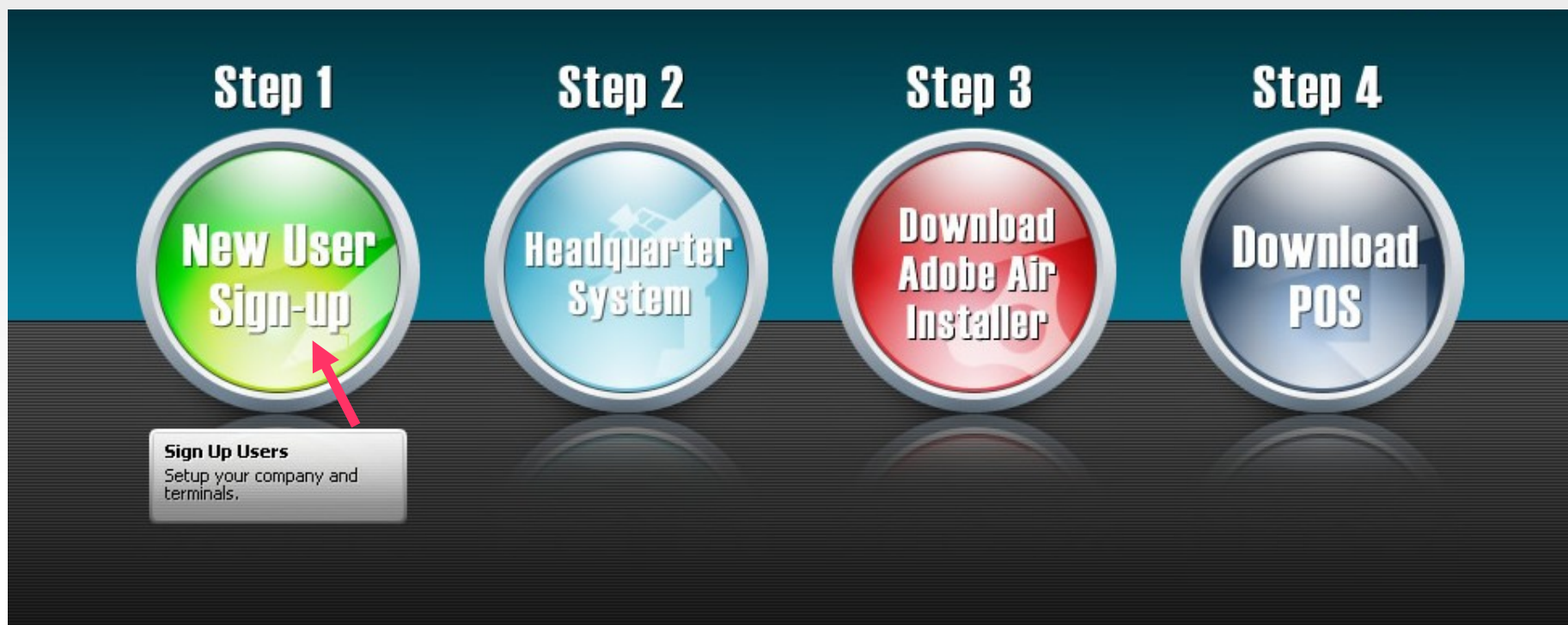

New User?

Sign Up for an Account

Email Address: *

First Name: *

Last Name: *

Phone Number: *

Please include country and area code (ie. 632-123-4567)

Password: *

Confirm Password: *

Security Question:

Answer: *

 Sign Up

Fill in all required fields (fields with *) including an active email address.

The password encoded here will be the same as the one required to access Control Panel and Headquarter modules.

You may choose from three security questions and encode your answer. This question-answer combination will be used when you forget your password.

Once done, click on Sign Up.



An email verification will be sent to the email address used in registration. Click on the link sent to your email address before you can proceed with WebPOS.

You have signed up with Alliance WebPOS.
Please confirm your account by clicking this link.

<http://app.alliancewebpos.com/appserv/confirm.php?id=@f2lx=G8QWxsawFuY2VXZWJQT1MsSIVTVEIOX1RPTkFDQU8yMTNAWUFIT08uQ09N@>

Your account information:

email: justin_tonacao213@yahoo.com
First Name: Justin
Last Name: Tonacao

If you did not register with us or somebody has mistakenly typed in your email address, please ignore this email.

Accounts not validated within 24 hours will be deleted automatically.

Thank you,
Alliance WebPOS Team
<http://app.alliancewebpos.com>

A confirmation page will display once your email address has been validated.

Click the Main Page link to direct you to the home page. You are now ready to login to the Administration Control Panel to register your company and terminals.

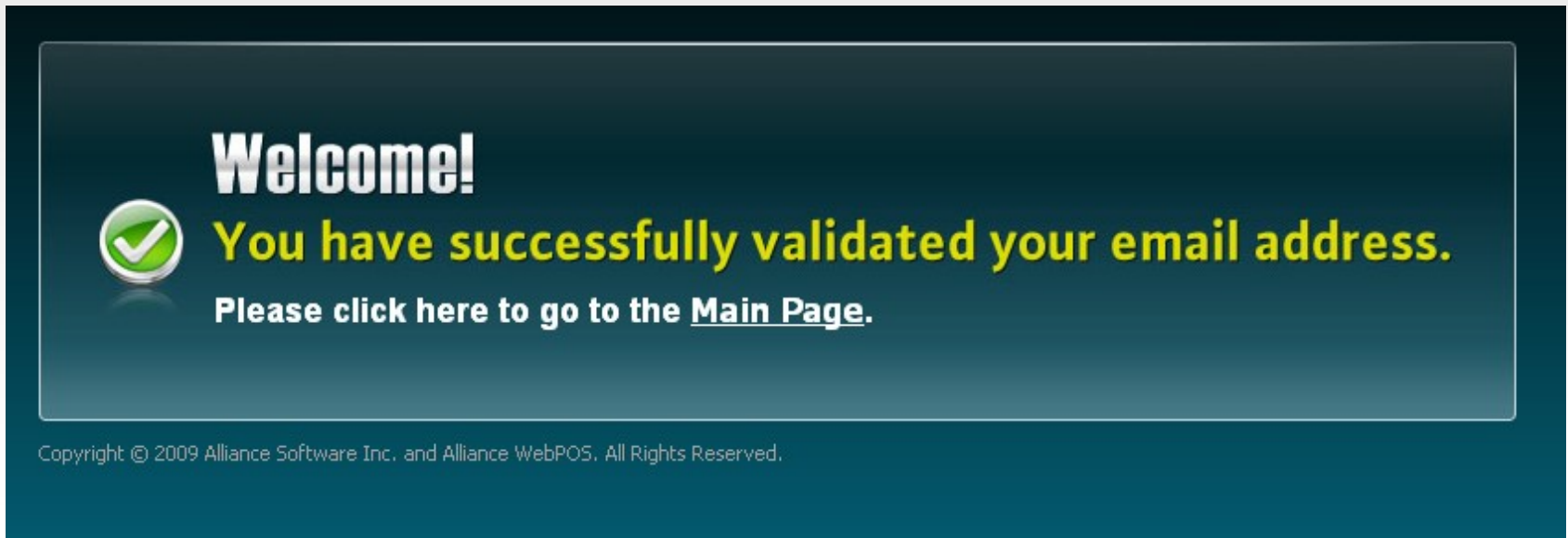

In the home page and click on  located at the upper right corner. You may also click on New User Sign-up.

To log in, enter email address and password under Security Verification.
Click on Sign On.

New User?

Sign Up for an Account

Email Address: *

First Name: *

Last Name: *

Phone Number: *

Please include country and area code (ie. 632-123-4567)

Password: *

Confirm Password: *

Security Question: **Where is your place of birth?** ▼

Answer: *

 Sign Up

Security Verification

Email Address: *

Password:

 Sign On

[Forgot Password?](#)

Click on [Forgot Password?](#) to reset password using your email address and security question-answer combination.

You will be redirected to your account's control panel home page with two panels: License Monitoring (left panel) and Company Set-up (right panel)

Click on Add Company on the lower right side to register your company.

Home Manage License Maintenance Logout V6.58.50.C01300

Dashboard

Welcome [Krystal Kaye Lee](#)

You have 0 registered company. You should start by creating a company.

You have 0 registered terminal.

License Expiring Within 60 days

Company Name	TM#	Expiry	Days Left

Filter: Any Column Clear Filter

Show License History Refresh

Companies You are Managing

# TM	Company ID	Company Name

Filter: Any Column Clear Filter

Detail **+ Company** + Terminal Refresh

To manage the company, select the Company Name on the right panel and click on the Detail button at the bottom of the panel.

You may access **Manage POS Terminal, Manage Logins, Manage Security Access, and Change Ownership of Company.**

Manage POS Terminal

add/edit terminal details

Manage Logins

add/remove users

Manage Security Access

edit access levels per user

Change Ownership of Company

register a new email address used to
manage the whole company